

GENERAL NOTES

- LEGAL BOUNDARY DATA OF 40 BLUE SPRINGS DRIVE FROM ACI SURVEY CONSULTANTS DATED SEPTEMBER 2017.
- EXISTING TOPOGRAPHICAL INFORMATION OBTAINED FROM SURVEY BY ACI SURVEY CONSULTANTS DATED SEPTEMBER 2017.
- BORHOLE LOCATIONS AND GEOTECHNICAL INFORMATION FROM REPORT BY CHUNG & VANDER DOELEN ENGINEERING LTD. DATED OCTOBER 2017.
- THIS SET OF PLANS SHALL NOT BE USED FOR CONSTRUCTION UNTIL STAMPED BY THE DESIGN ENGINEER AND APPROVED BY THE LOCAL MUNICIPALITY.
- NO CHANGES ARE TO BE MADE WITHOUT THE APPROVAL OF THE DESIGN ENGINEER.
- THIS PLAN NOT TO BE REPRODUCED IN WHOLE OR IN PART WITHOUT THE PERMISSION OF WALTERFEDY.
- THE POSITION OF POLE LINES, CONDUITS, WATERMANS, SEWERS, AND OTHER UNDERGROUND AND OVERGROUND UTILITIES AND STRUCTURES IS NOT NECESSARILY SHOWN ON THE CONTRACT DRAWINGS AND, WHERE SHOWN, THE ACCURACY OF THE POSITION OF SUCH UTILITIES AND STRUCTURES IS NOT GUARANTEED. BEFORE STARTING WORK, THE CONTRACTOR SHALL INFORM HIMSELF OF THE EXACT LOCATION OF ALL SUCH UTILITIES AND STRUCTURES AND SHALL ASSUME ALL LIABILITY FOR DAMAGE TO THEM AND THOSE NOT LOCATED PRIOR TO CONSTRUCTION.
- ANY AREA DISTURBED DURING CONSTRUCTION SHALL BE RESTORED TO ITS ORIGINAL CONDITION OR BETTER TO THE SATISFACTION OF THE CONSULTANT AND AUTHORITY HAVING JURISDICTION. THE CONTRACTOR IS RESPONSIBLE FOR RESTORING ALL DAMAGED AND/OR DISTURBED PROPERTY WITHIN THE MUNICIPAL RIGHT-OF-WAY TO MUNICIPAL STANDARDS.
- ALL HEALTH AND SAFETY RELATED SIGNAGE MUST BE POSTED AT THE SITE AS REQUIRED BY APPLICABLE LAW AND BEST MANAGEMENT PRACTICES.
- INVERTS AND PIPE DIAMETERS FOR SERVICES ON BLUE SPRINGS DRIVE WERE TAKEN FROM DRAWING NO. S-965 PROVIDED BY THE CITY OF WATERLOO. REMAINING INVERTS AND PIPE SIZES WERE TAKEN FROM THE TOPOGRAPHICAL SURVEY COMPLETED BY ACI SURVEY CONSULTANTS DATED SEPTEMBER 2017 AND CROSS REFERENCED WITH THE MECHANICAL SITE PLAN PROVIDED BY THE OWNER. THIS INFORMATION IS TO BE FIELD VERIFIED BY THE CONTRACTOR.

LEGEND

- PROPERTY LINE
- PROPOSED SANITARY SERVICE
- PROPOSED STORM SERVICE
- PROPOSED WATER SERVICE
- PROPOSED GRADE
- EXISTING FLOODLINE (ELEV. VARIES)
- EX CB
- EX DCB
- EX MH
- EX CBMH
- EX SAN MH
- EX HYD
- EX WV
- MH
- CBMH
- CB
- ← PROPOSED OVERLAND FLOW ROUTE

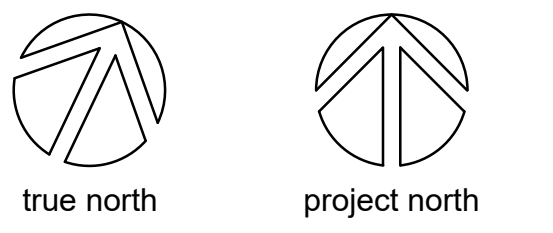
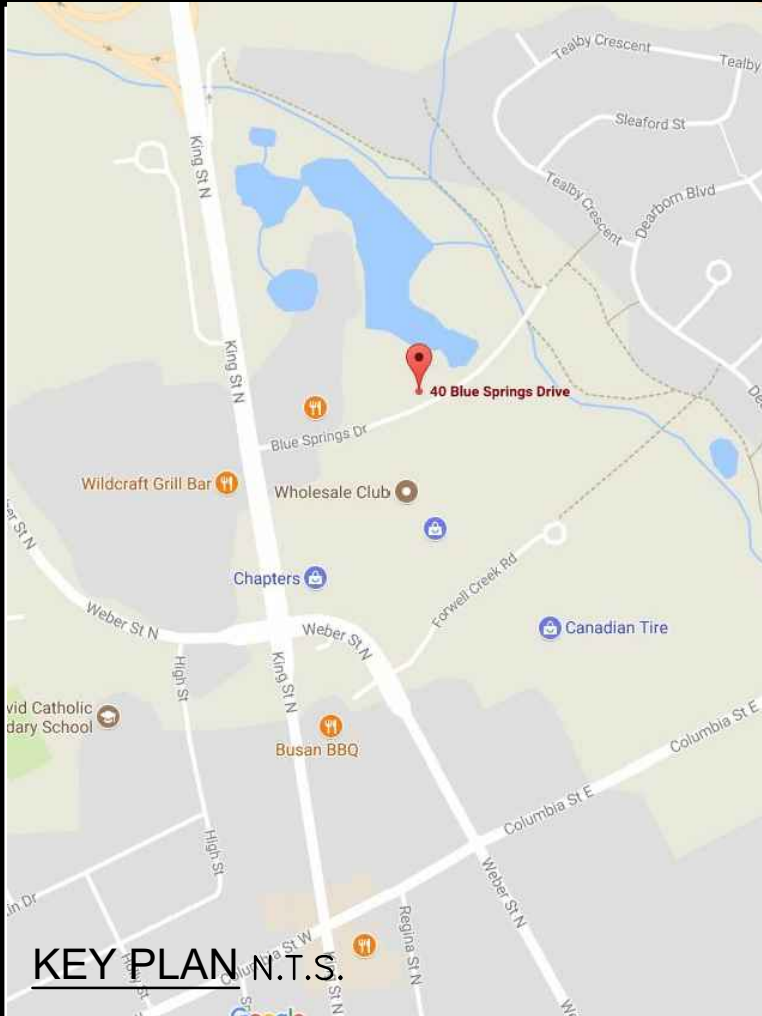

date	issued
2017.12.06	ISSUED WITH FUNCTIONAL SERVICING REPORT
2018.12.03	REISSUED WITH FUNCTIONAL SERVICING REPORT

date	revision	no.

customer
THE CLUB WILLOWELLS

project
**CLUB WILLOWELLS
40 BLUESPRINGS DRIVE
WATERLOO, ON**

title
**SCHEMATIC GRADING AND
FUNCTIONAL SERVICING PLAN**

WALTERFEDY

675 Queen Street South, Suite 111
Kitchener, Ontario, Canada N2M 1A1
T 519.576.2150 F 519.576.4999
walterfedy.com



The contractor shall check and verify all dimensions and report any errors or omissions to the consultant before commencing or proceeding with any work. Do not scale this drawing.

Copyright © 2016 WalterFedy	scale: 1:300	sheet no.:
	date: 2017.11.17	
	job no.: 2014-0300-12	
	CAD file: 2014-0300-12_PL0T	
	drawn by: TK	
checked by:		

C2-1

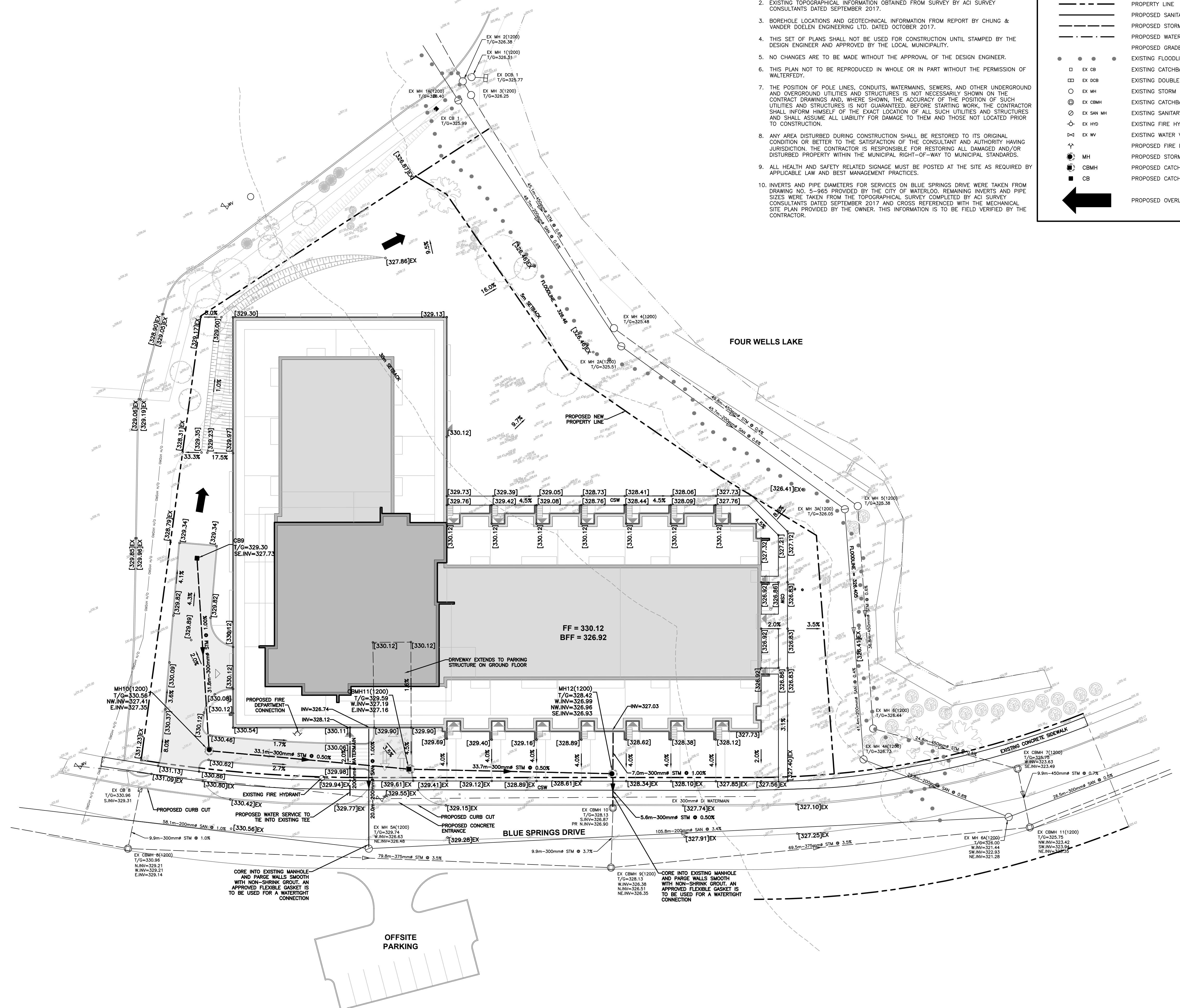

\\BELT\pba_fpe\2014\0300\2014-0300-12_PL0T_C2-1.dwg: Previous paper size (914.48 x 609.60 mm), DWG TO PDF no. lynesact; Tyler Miller, 2018-12-03 4:07:45 PM